

**RECEIVED**  
 SEP 23 2003

23RD STREET

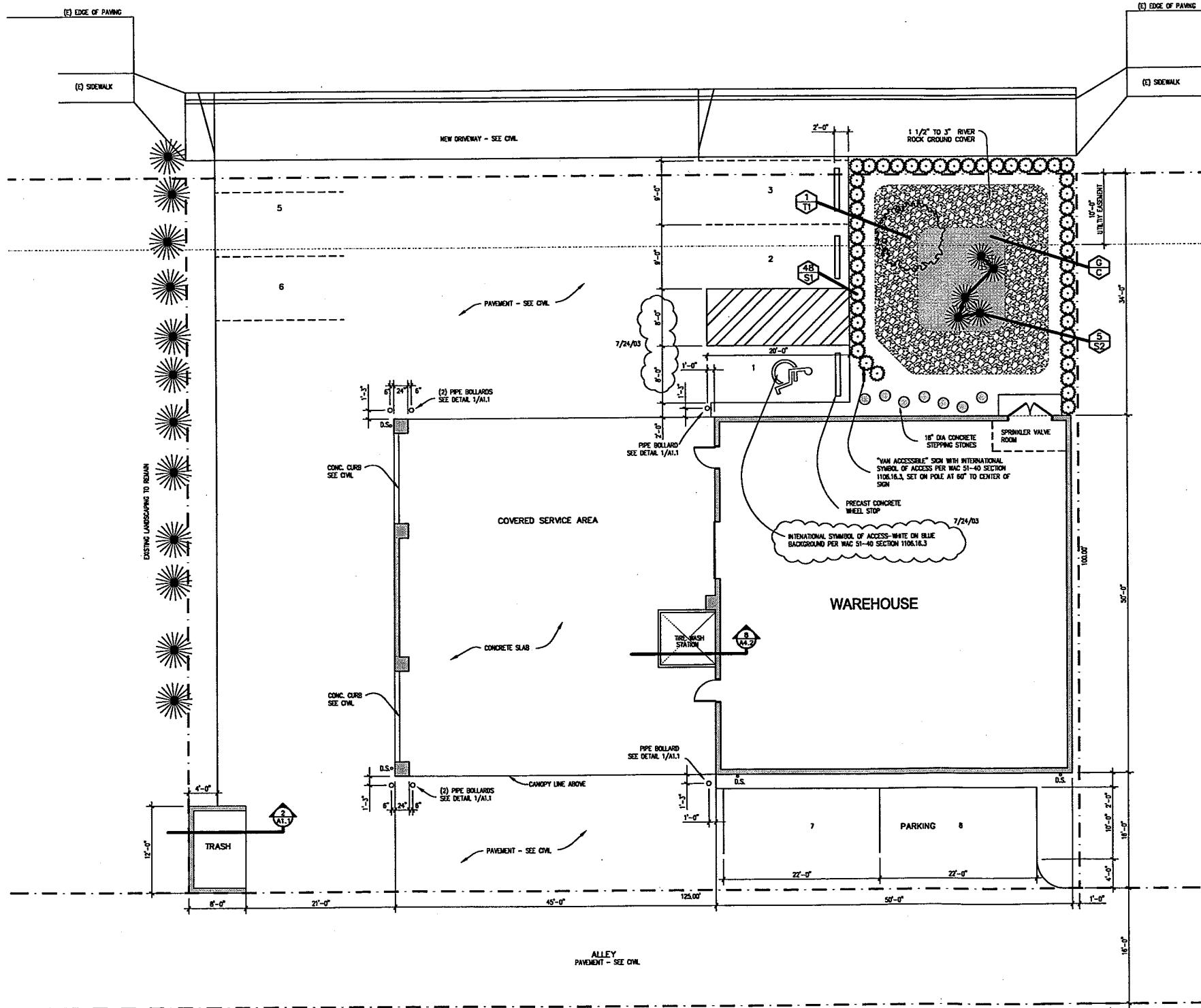

MARK	PLANT MARK QUANTITY IN GROUP	BOTANICAL NAME	COMMON NAME	SIZE
<b>TREES</b>				
T1		SALIX "CAPREA"	FRENCH PUSSY WILLOW	2" CAL.
S1		PHOTINIA "BRASER"		48" INITIAL HEIGHT AT 24" OC
S2		TYPHA "LATIFOLIA"	COMMON CAT-TAIL	2 CAL.
<b>GROUND COVER (GC)</b>				
	60 - 70 PERCENT	TALL FESCUE		
	10 - 15 PERCENT	SEASIDE / COLONIAL BENTGRASS		
	10 - 15 PERCENT	MEADOW FOXTAIL		
	6 - 10 PERCENT	ALSIKE CLOVER		
	1 - 5 PERCENT	MARSHFIELD BIG TREFOIL		
	1 - 6 PERCENT	REDTOP		

**Underwood & Schwab Architects, LLC**  
 909 Seventh Street  
 Anacortes, WA 98221  
 360-568-0471  
 MIKE UNDERWOOD  
 PAUL SCHWAB  
 E-mail: mkunderwood@isomedia.com

NOTES

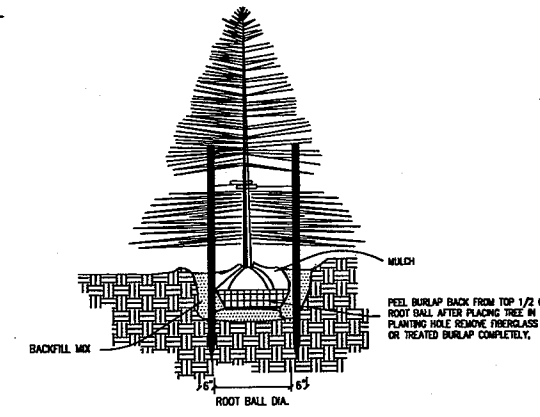

TREE PLANTING DETAIL  
 NOT TO SCALE

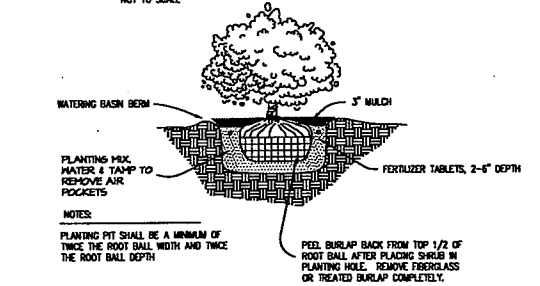

SHRUB PLANTING DETAIL  
 NOT TO SCALE

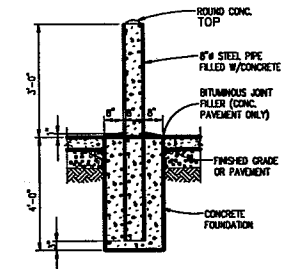

PIPE GUARD DETAIL  
 N.T.S.

NOTE: STEEL PIPE SHALL BE GALVANIZED (3.0 OZ. ZINC/SD. FT.) & HAVE A MINIMUM WALL THICKNESS OF 0.125" MIN.

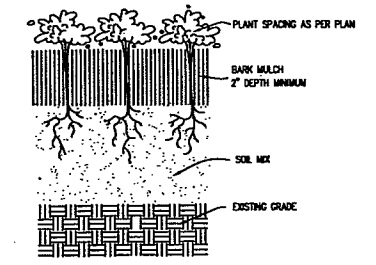

GROUNDCOVER INSTALLATION  
 NOT TO SCALE

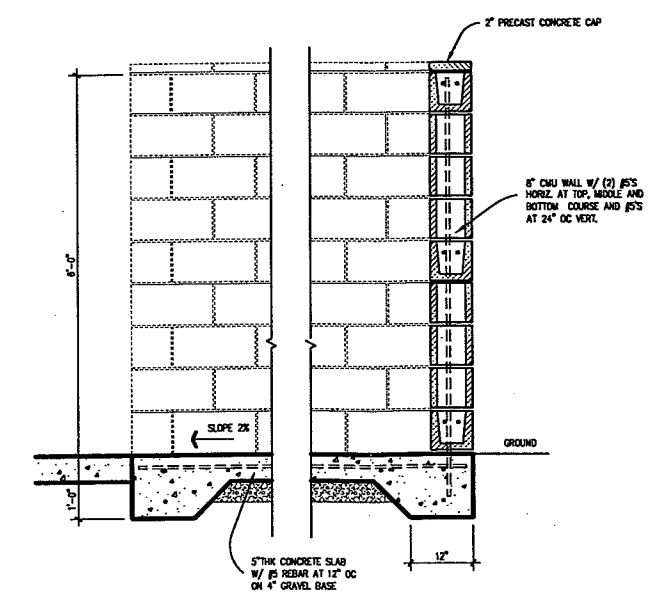

DUMPSTER ENCLOSURE  
 1" = 1'-0"

**ARCHITECTURAL SITE PLAN**  
 SCALE: 1/4" = 1'-0"

**Les Schwab Wallgren Tire Center**  
 OWNER  
 Anacortes, WA

**ARCHITECTURAL SITE PLAN**  
 DATE: 5/6/03  
 SHEET: A1.1  
 REV: 7/24/03  
 LANDSCAPE REV: 9/24/03  
 SHEETS

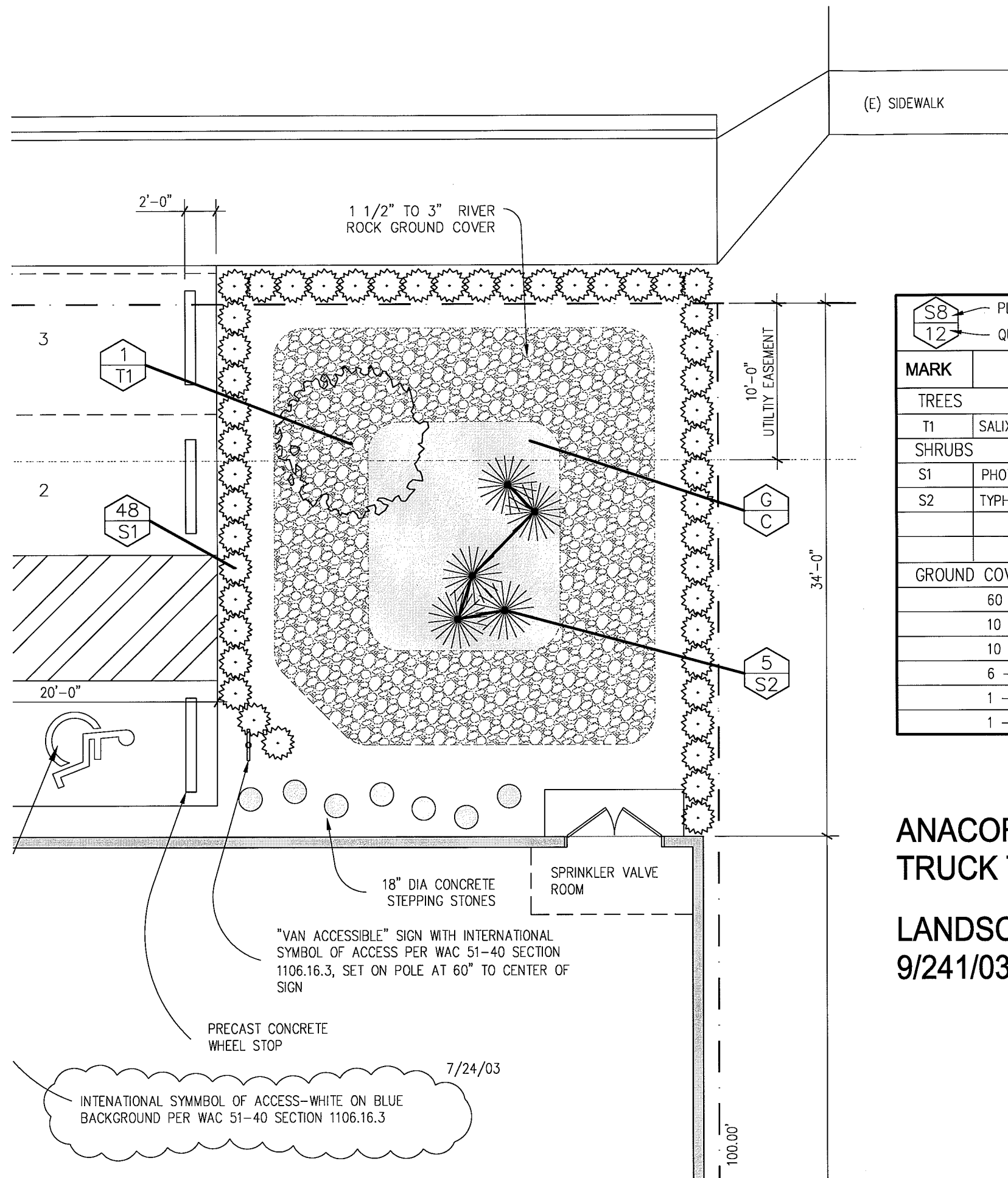

PLANT LIST			
MARK	BOTANICAL NAME	COMMON NAME	SIZE
TREES			
T1	SALIX "CAPREA"	FRENCH PUSSY WILLOW	2" CAL.
SHRUBS			
S1	PHOTINIA "FRASERI"		48" INITIAL HEIGHT AT 24" OC
S2	TYPHA "LATIFOLIA"	COMMON CAT-TAIL	2 GAL.
GROUND COVER (GC)			
60 - 70 PERCENT		TALL FESCUE	
10 - 15 PERCENT		SEASIDE / COLONIAL BENTGRASS	
10 - 15 PERCENT		MEADOW FOXTAIL	
6 - 10 PERCENT		ALSIKE CLOVER	
1 - 5 PERCENT		MARSHFIELD BIG TREFOIL	
1 - 6 PERCENT		REDTOP	

**ANACORTES LES SCHWAB  
TRUCK TIRE CENTER**

**LANDSCAPE REVISIONS  
9/24/03**

7/24/03

INTENATIONAL SYMBOL OF ACCESS-WHITE ON BLUE  
BACKGROUND PER WAC 51-40 SECTION 1106.16.3